



COMPACT & RELIABLE

HYDROCLEAR GRP TREATMENT PLANTS



NEW

FREE SITE VISIT AVAILABLE



Manufactured in the UK, our range of Sewage Treatment Plants are perfect for a wide range of off-mains drainage applications.

 @harlequinMFG

www.harlequinplastics.co.uk

Harlequin®
MANUFACTURING FOR TOMORROW



NEW

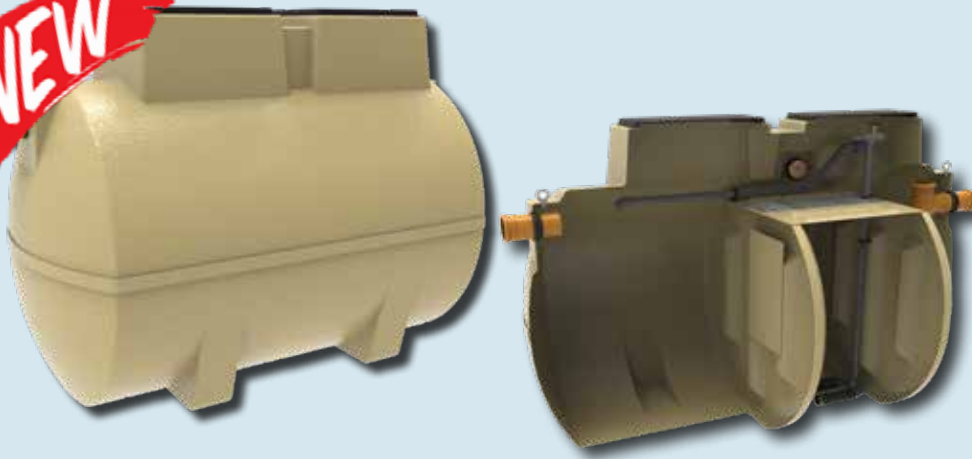

**MARKET LEADING
POLLUTANT REMOVAL**

97.5%

**Internal view
of a Harlequin
6 person GRP
plant**

TECHNICAL SPECIFICATIONS

Population Served	1-6
Desludging Intervals (Months)	12*
Inlet Invert (mm)	500
Outlet Invert (mm)	575
Blower Ratings (W)	76
Length (mm)	2425
Width (mm)	1325
Height (mm)	1640
Weight (kg)	200
Cover Sizes (mm)	600X450

Deeper inverts available on request** | Pumped outlets available

**External Compressor
available as standard**



*Desludge intervals depending on usage
**Deeper inverts to be made in the factory and cannot be retrofitted on site

KEY FEATURES

- Super Quiet*
- Pollutant Removal Level of 97.5%
- Reliable MBBR System
- Structurally Strong
- Option of Internal Compressor
- Odourless
- Low Maintenance Costs
- Compact System
- 2-year Warranty**
- Small Low Profile Covers
- Certified for use in the UK in compliance with EN12566-3
- Various invert levels available
- Suitable for Trafficked Areas***

*When installed in accordance with manufacturers instructions
**2 year warranty only when product is registered on our website
***Subject to a suitable slab designed by a Structural Engineer

Harlequin Manufacturing Ltd

Head Office
21, Clarehill Road
Moirra, Northern Ireland
BT670PB

Factory in England
Unit 1, Lancaster Business Park
East Kirkby, Lincolnshire
PE23 4BH

Please Note: All tank capacities are brimful. All information contained herein is understood to be correct at time of publication. Harlequin reserve the right to amend product specification without notice.

T 028 9261 1077 E sales@harlequin-mfg.com
www.harlequinplastics.co.uk

Harlequin®
MANUFACTURING FOR TOMORROW